

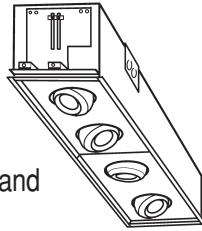

Multi-head Adjustable Accent modules with a clean closed face. Use them alone or mix and match with our DLTB Series Down Lights or our DWTB or MPTB Series Wall Washers.



INSTALLATION INSTRUCTIONS

AAMTB SERIES T-Bar Mounting

FOR SUPPLY CONNECTIONS ENTERING THIS FIXTURE USE WIRE SUITABLE FOR AT LEAST 90° C

*** INSTALLATION TO BE DONE IN ACCORDANCE WITH NEC AND APPLICABLE CODES ***

1. For most installations, secure the fixture to T-Bar (typical as shown, or per local regulations).

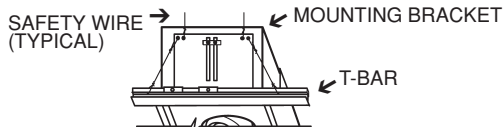

2. Mount fixture to sit on top of T-Bar. To correct height, adjust the mounting brackets with the screws inside the fixture.



MR-16 Lamps:

3. Connect power through the cover plate or knock-outs. To access the transformer, after installation, push the spring clip at the edge of the fixture to allow the face to drop down.

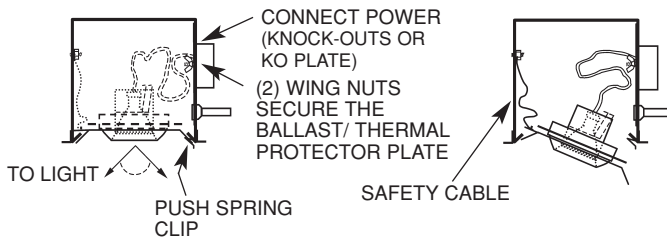

4. Release the Ballast/Thermal Protector plate by removing the wing nuts and maneuvering out of the face of the fixture. MR-16 lamp plugs into socket and slides into lamp shroud. Squeeze lamp clip over lamp to secure.

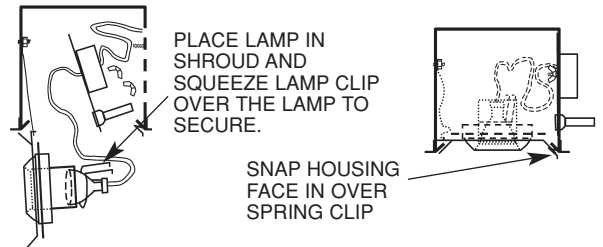

Halogen Par Lamps:

3. Connect power through the cover plate or knock-outs. To open the fixture for service/lamp replacement, push the spring clip at the edge of the fixture to allow the face to drop down.

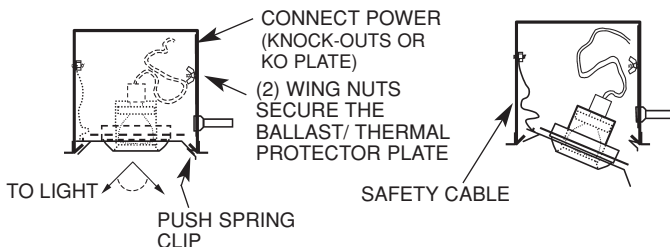

4. Remove Thermal Protector plate if required by removing the wing nuts and maneuvering out of the face of the fixture. Lamp securing disk is held over lamp with screw.

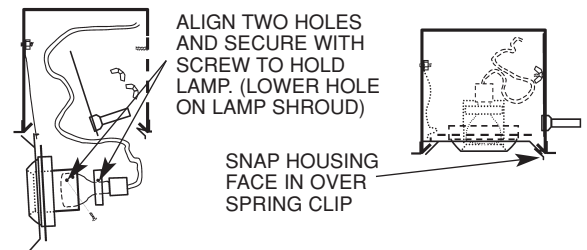

Metal Halide Par Lamps:

3. Connect power through the cover plate or knock-outs. To access the ballast, after installation, push the spring clip at the edge of the fixture to allow the face to drop down.

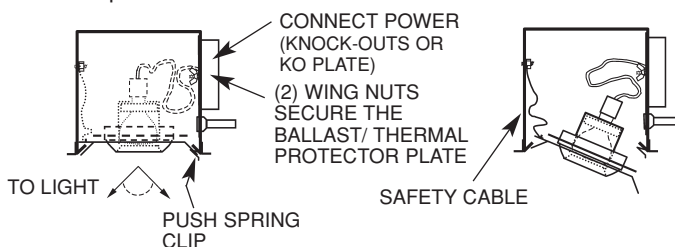

4. Release the Ballast/Thermal Protector plate by removing the wing nuts and maneuvering out of the face of the fixture. Lamp securing disk is held over lamp with screw.

