

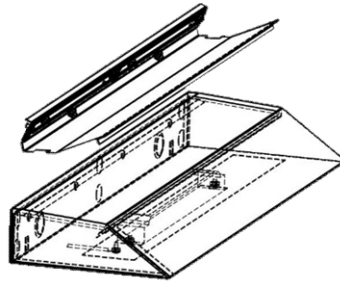

INSTALLATION INSTRUCTIONS

CLK SERIES
Surface Mount Cove Light



FOR SUPPLY CONNECTIONS
ENTERING THIS FIXTURE USE WIRE
SUITABLE FOR AT LEAST 90° C

*** INSTALLATION TO BE DONE IN ACCORDANCE WITH *NEC* AND APPLICABLE CODES ***

The CLK Series is designed to be surface mounted directly to the wall. Units may be installed individually or in a continuous run with multiple units. Access for service and maintenance may be done through the fixture opening. Wall **BLOCKING** for mounting is recommended. Mounting holes and knockout location diagram can be found on page 2. To access knockout for power feed and the mounting holes first remove the reflector/LED component as follows:

1. If your unit is equipped an optional lens simply lift it out.
2. To remove the reflector push the lip of the reflector (opposite from the LED) with your thumb or non-marring tool towards the LED side of the fixture, dislodging it.

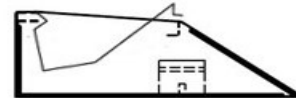
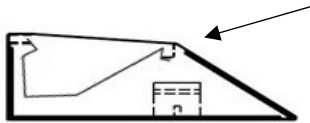

3. Pull the reflector out. Carefully disconnect wire leads. Driver, knock outs and mounting holes are now accessible.
4. After mounting fixture to the wall, reverse this procedure to replace reflector/LED.

MOUNTING

1. Using an extended driver bit mount to structure (blocking recommended) through the mounting holes. If installing multiple fixtures continuously, leave mounting fasteners slightly loose until fixture to fixture joining and alignment is complete . See page 2.

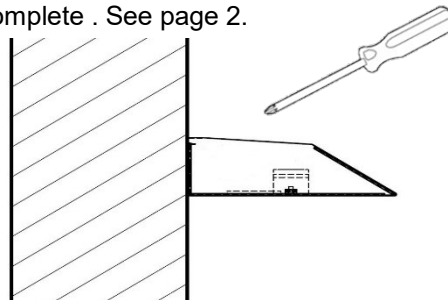



INSTALLATION INSTRUCTIONS

CLK SERIES
Surface Mount Cove Light

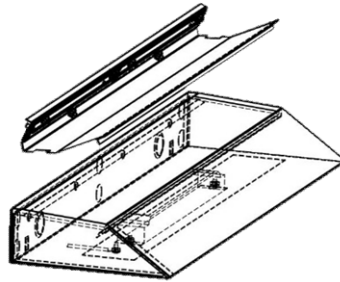

FIXTURE ALIGNMENT

1. With fixtures mounted and slightly loose from wall, use the included fasteners to join one fixture to another. Adjust to align front edges and tighten. See illustration below.
2. When alignment is complete secure wall fasteners completely.

Fixture to fixture mounting hole

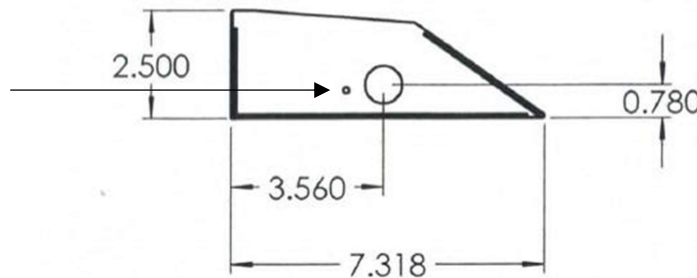

When mounting is complete make final power feed connections and re-install reflector/LED component following procedure on page 1.

Mounting Hole and Knock Out Location Diagram

