

INSTALLATION INSTRUCTIONS

HITW-EX SERIES Exterior "Hole in the Wall" Wet Location Light Niche Suitable for Concrete Pour

Ideal placement of the exterior low level floodlight "Hole in the Wall" is 18" and 30" from the bottom edge of the fixture to the ground.

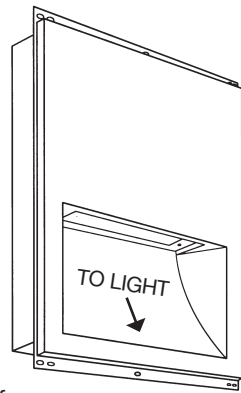

FOR SUPPLY CONNECTIONS ENTERING THIS FIXTURE WITHIN 3 INCHES OF A BALLAST USE WIRE SUITABLE FOR AT LEAST 90° C. FIXTURE IS NON I.C. RATED.

★ **Installation must be coordinated between the electrical and exterior finish contractors.**

- 1.** Mount fixture to 16" on center studs and allow for power feed through framing. **Fixture must mount to be flush with finish surface.**
- 2.** Bring power through the fixture black box and out the cast opening, **allow at least 16" of additional flexible conduit.**

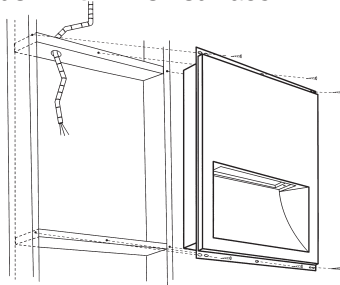

- 3.** Finish the building exterior and paint fixture to match (lower light levels occur with dark paint).
★ **See possible joining edge detail.**

- 4.** Pull power conduit through gasket and into the ballast/wiring compartment with **watertight connector**. **Fill conduit at connector with silicone**. Knock-outs provided for through wiring.

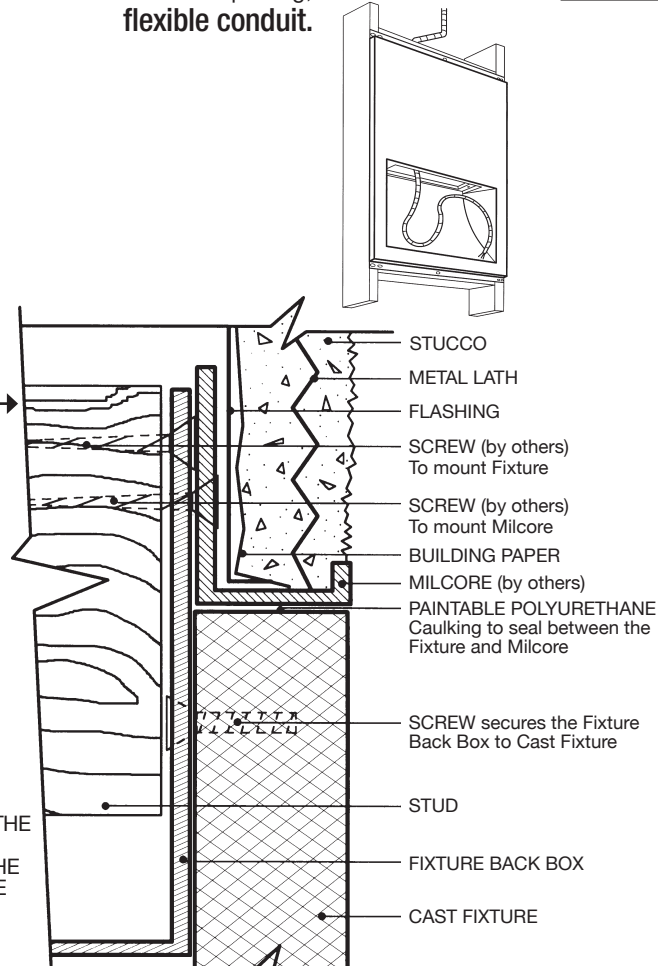
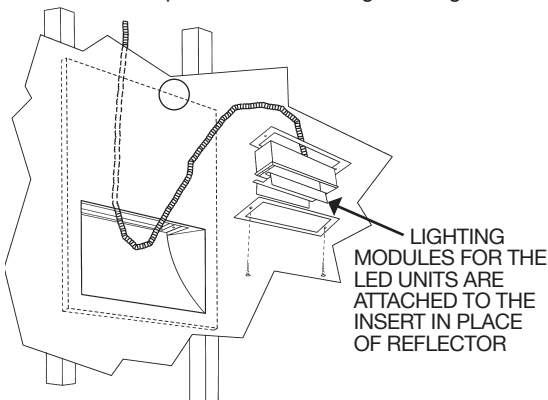

★ **CONTRACTOR IS RESPONSIBLE FOR THE WATERPROOF SEAL WHERE THE STUCCO JOINS FIXTURE.**

- 5.** To apply a finish to the face of fixture to match the exterior building, use "Weld-Crete" and follow the manufacturer's instructions.

- 6.** Insert the components of the fixture in the order shown above: 1) Gasket; 2) Ballast compartment; 3) Reflector (remove protective film), then lamp and test fixture; then 4) Faceplate/Lens assembly.

- 7.** **Put small amount of silicone into the screw holes.** Then tighten down faceplate with supplied screws.

