

# ELP

ENGINEERED LIGHTING  
PRODUCTS

## HITW SERIES

### RECESSED Hole In The Wall Light Niche For Plaster or Drywall

Project  
Dr. Rosen & Shepard D.D.S.  
Westlake Village, California

Specifier  
Mar-Vista Sales  
Santa Paula, California

Photographer  
Mark Dell'Aquila  
Long Beach, California

Lighting  
155BX-HITW-8x29, 55 watts

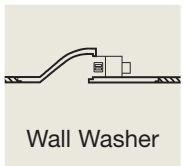

Wall Washer



Floor  
Washer

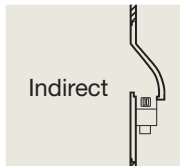

Indirect

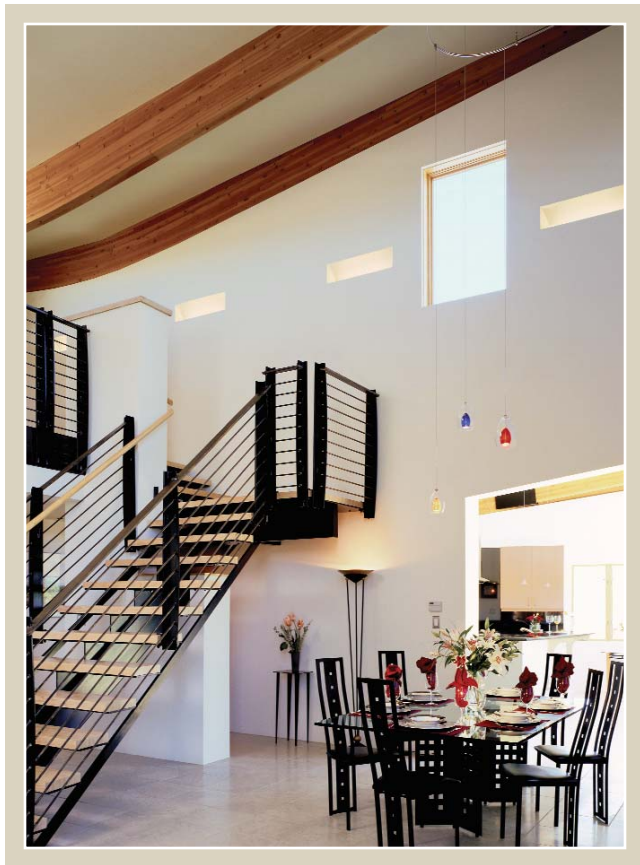

Project  
Colorado Residence

Architect  
Davis Partnership Architects  
Denver, Colorado

Specifier  
Onie Chamberlain  
Centerline Resources, Inc.  
Denver, Colorado

Photographer  
Ron Ruscio  
Greenwood Village, Colorado

Lighting  
155BX-HITW-8x29, 55 watts

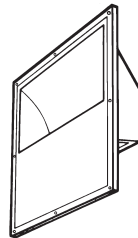

*Cast Fixtures with asymmetric light wash that integrate into your wall or ceiling for the custom built look of a drywall light niche.*

### System

Rectangular, Square and Arched aperture fixtures that are cast with GRG (Glass fiber Reinforced Gypsum) composite material. Once installed, the fixture actually appears to be part of your wall or ceiling and looks like a custom formed drywall "light niche" that blends with any interior motif.



TYPE:  
CATALOG #:  
JOB:

RECESSED Hole In The Wall Light Niche  
For Plaster or Drywall

## Specifications

Recessed fixture for use with several compact fluorescent, incandescent, halogen and LED lamping options. The GRG fixture is fiberglass reinforced cast plaster with integral electrical components. The casting houses an electrical box that includes wiring, socket(s), reflector and ballast for fluorescent units. The metal "fixture insert" is 20 gauge CRS that is post painted with TGIC polyester powder coating, with cover and knock-outs for wiring. All fluorescent units are supplied standard with Luminaire Disconnect.

Electrical components are accessible through the fixture opening. Electrical box provides knock-outs for through wiring. Casting mounts directly to stud construction. Allowance is made for 5/8" gypsum board construction butting fixture. Once installed the fixture actually appears to be part of your wall and looks like a custom formed drywall "light niche."

The shallow 3-1/2" fixture may be recessed into a standard 4" wall to wash the ceiling or floor with light. By lining the "wall recess" with gypsum, the wall installation may also be modified to maintain a one hour fire rating (SEE INSTRUCTIONS).

**NOTE: Please do not specify or try to install this product without clear understanding of the installation instructions.**

UL/CUL Damp Location listed. Non I.C. Rated.

**U.S. Patent # 7,108,394**

## Options

Ballast/	120 or 277 Electronic (Standard)
Circuit	120 or 277 LED
	Dimming (Some models) -DM
Mini	Clear Lexan (Some Fluorescent) -ML
Lens	Frosted Lexan (Some Fluorescent) -MLF
	Clear Tempered Glass -ML-TGL**
	Frosted Tempered Glass -ML-TGLF*
Louver	Honeycomb, Silver -LVS
	Honeycomb, Black -LVB
Insert Finish	White (Standard)
	Anti-Microbial White -MB
MRI	Non-Ferrous Metal
	(Only ▲ Models) -MRI
	(Insert with Anti-Microbial Paint)
Hospital	Hospital Grade for Insert -HG
	(Lens; Gasket; Anti-Microbial Paint)

\* Fixtures Indicated are supplied Standard with Frosted Tempered Glass. Clear Tempered Glass may be substituted if required.

\*\* Fixtures Indicated are supplied Standard with Clear Tempered Glass. Frosted Tempered Glass may be substituted if required.

‡ Dimming Ballast Available for this model with modified installation. Contact factory for detail.

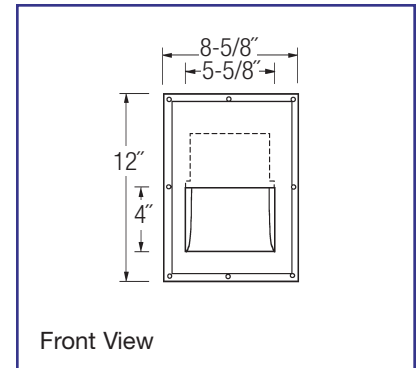
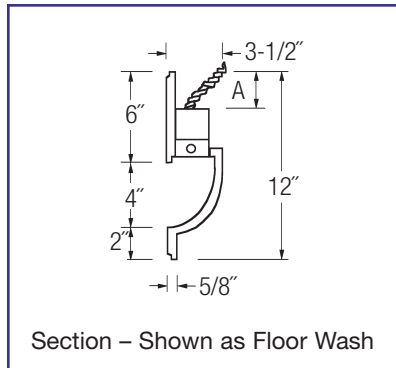

Model No.	A	Lamp
125HAL-HITW-4x6* ▲	1-1/4"	25 watt T-4 Halogen, G9
110IN-HITW-4x6* ▲	1-1/4"	10 watt C7 Nightlight
11C-HITW-4x6**	3"	1 Row, 1 CCT White LED
22C-HITW-4x6**	3"	2 Rows, 2 CCT White/Amber LED

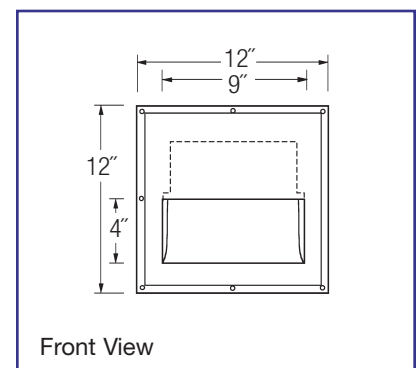
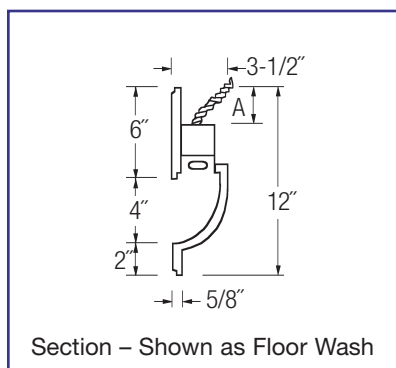

Model No.	A	Lamp
125IN-HITW-4x9 ▲	1"	25 watt T-8 Inc. Candelabra
140HAL-HITW-4x9** ▲	1"	40 watt T-4 Halogen, G9
105 PL-HITW-4x9	3"	5 watt PL
107 PL-HITW-4x9	3"	7 watt PL
109 PL-HITW-4x9	3"	9 watt PL

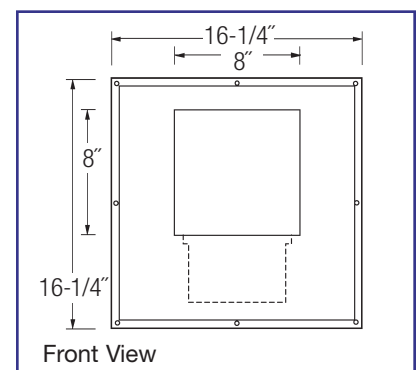
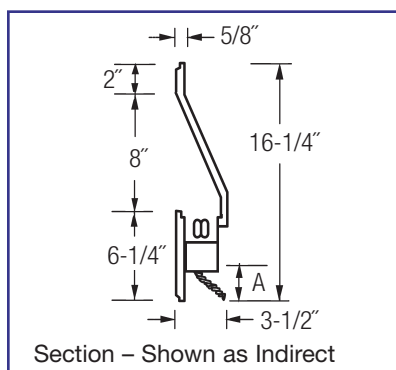

Model No.	A	Lamp
140HAL-HITW-8x8** ▲	1"	40 watt T-4 Halogen, G9
118 TT-HITW-8x8‡	2-3/4"	18 watt Triple Tube
126 TT-HITW-8x8‡	2-3/4"	26 watt Triple Tube



# HITW SERIES

TYPE:  
CATALOG #:  
JOB:

RECESSED Hole In The Wall Light Niche  
For Plaster or Drywall

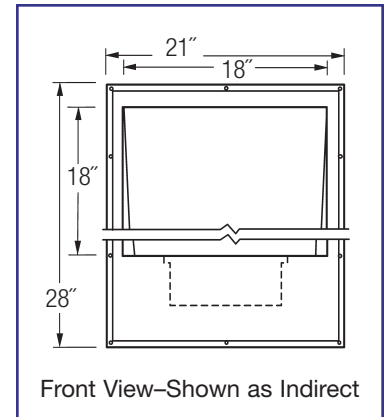
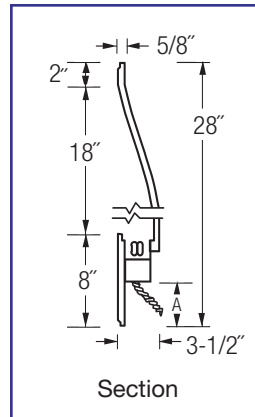
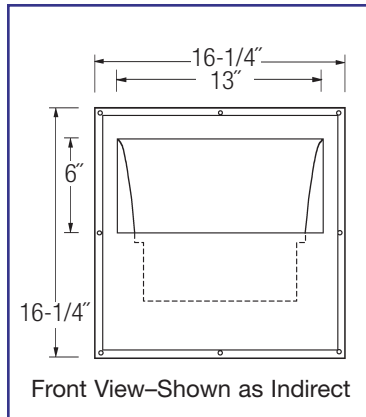
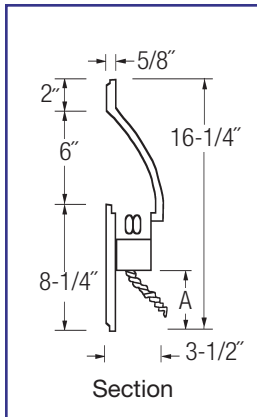

Model No.	A	Lamp
160 IN-HITW-6x13 ▲	2-3/4"	60 watt T-10 Inc.
170 HAL-HITW-6x13 ▲	2-3/4"	70 watt BT-15 Halogen
113 PL-HITW-6x13	4-1/2"	13 watt PL
118 QD-HITW-6x13†	4-1/2"	18 watt Quad
126 QD-HITW-6x13†	1-1/2"	26 watt Quad
132 TT-HITW-6x13†	1-1/2"	32 watt Triple Tube
142 TT-HITW-6x13†	1-1/2"	42 watt Triple Tube

Model No.	A	Lamp
160 IN-HITW-18x18 ▲	2-1/2"	60 watt T-10 Inc.
170 HAL-HITW-18x18 ▲	2-1/2"	70 watt BT-15 Halogen
113 PL-HITW-18x18	4-1/2"	13 watt PL
118 QD-HITW-18x18†	1-3/8"	18 watt Quad
126 QD-HITW-18x18†	1-3/8"	26 watt Quad
132 TT-HITW-18x18†	1-3/8"	32 watt Triple Tube
142 TT-HITW-18x18†	1-3/8"	42 watt Triple Tube

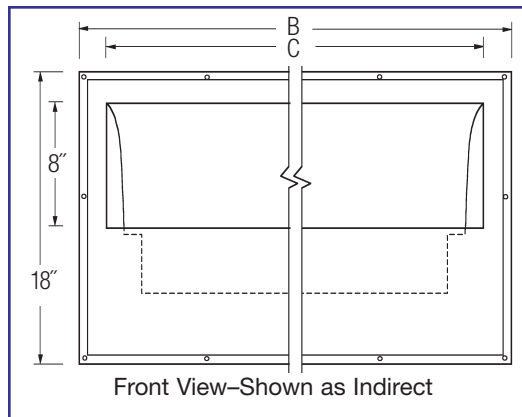
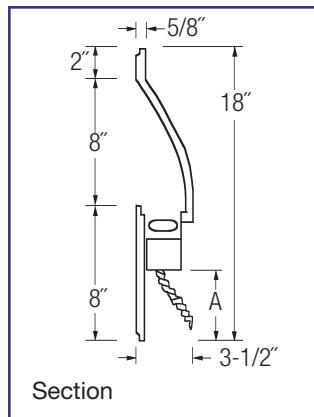

Model No.	A	B	C	Lamp
140 BX-HITW-8x29†	4-1/2"	32"	29"	40 watt Biax
150 BX-HITW-8x29†	4-1/2"	32"	29"	50 watt Biax
155 BX-HITW-8x29†	4-1/2"	32"	29"	55 watt Biax
240 BX-HITW-8x54†	4-1/2"	58"	54"	(2) 40 watt Biax
250 BX-HITW-8x54†	4-1/2"	58"	54"	(2) 50 watt Biax
255 BX-HITW-8x54†	4-1/2"	58"	54"	(2) 55 watt Biax
128 T5-HITW-8x54†	4-1/2"	58"	54"	28 watt T-5
154 T5-HITW-8x54†	4-1/2"	58"	54"	54 watt T-5 HO
132 T8-HITW-8x54†	4-1/2"	58"	54"	32 watt T-8

† Dimming Ballast Available for this model.



# HITW SERIES

TYPE:  
CATALOG #:  
JOB:

## RECESSED Hole In The Wall Light Niche For Plaster or Drywall

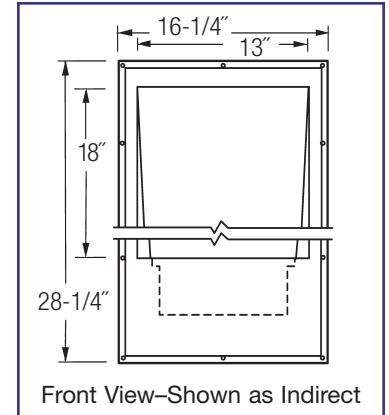
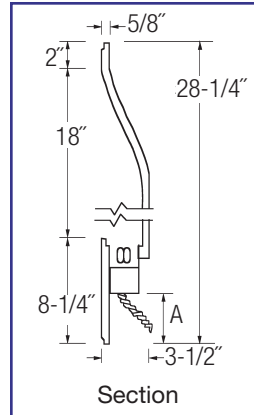
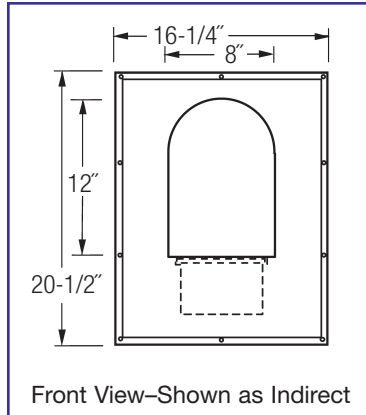
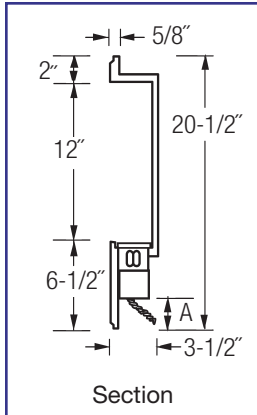

Model No.	A	Lamp
140 HAL-HITW-12x8R* ▲	1-1/4"	40 watt T-4 Halogen, G9
118 TT-HITW-12x8R†*	3"	18 watt Triple Tube
126 TT-HITW-12x8R†*	3"	26 watt Triple Tube

Model No.	A	Lamp
160 IN-HITW-18x13 ▲	2-3/4"	60 watt T-10 Inc.
170 HAL-HITW-18x13 ▲	2-3/4"	70 watt BT-15 Halogen
113 PL-HITW-18x13	4-1/2"	13 watt PL
118 QD-HITW-18x13†	4-1/2"	18 watt Quad
126 QD-HITW-18x13†	1-1/2"	26 watt Quad
132 TT-HITW-18x13†	1-1/2"	32 watt Triple Tube
142 TT-HITW-18x13†	1-1/2"	42 watt Triple Tube

† Dimming Ballast Available for this model with modified installation.  
Contact factory for detail.

### Installation

NOTE: Fixture should be installed by the drywall contractor and wired by the electrical contractor.

### SEE DETAILED INSTALLATION INSTRUCTIONS

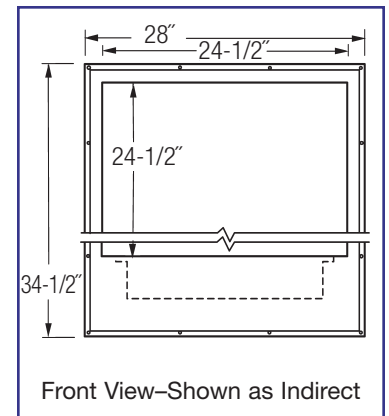
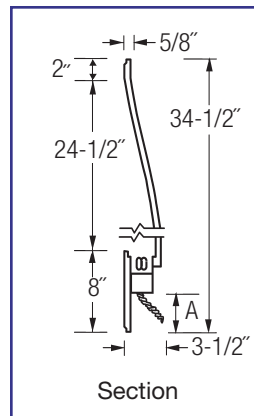
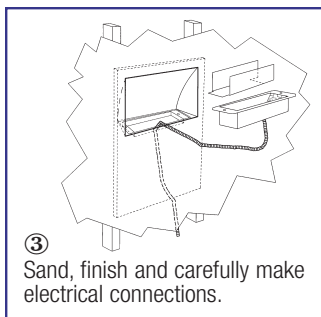
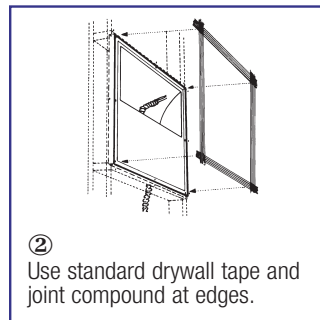
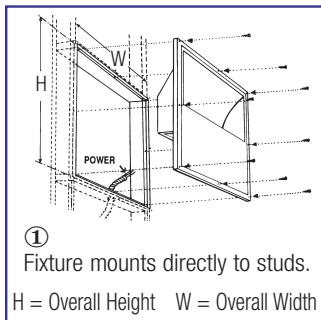

Model No.	A	Lamp
140 BX-HITW-24x24†	4-1/2"	40 watt Biax
150 BX-HITW-24x24†	4-1/2"	50 watt Biax
155 BX-HITW-24x24†	4-1/2"	55 watt Biax

† Dimming Ballast Available for this model.