

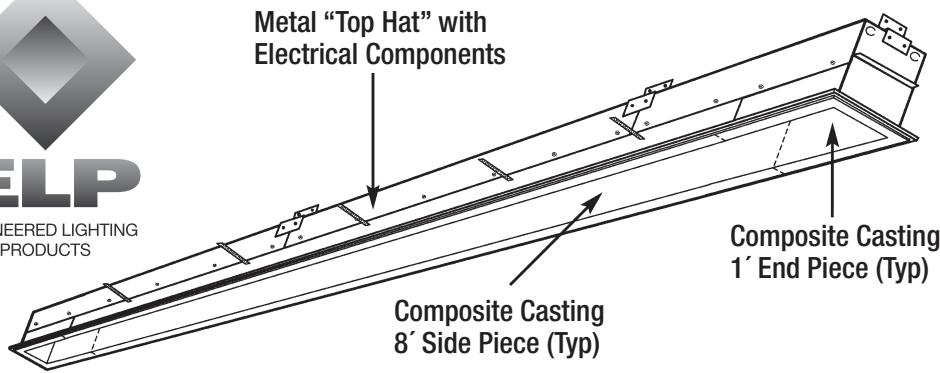

INSTALLATION INSTRUCTIONS

Slot In The Ceiling Continuous Mounting

FOR SUPPLY CONNECTIONS ENTERING THIS FIXTURE USE WIRE SUITABLE FOR AT LEAST 90° C. FIXTURE IS NON I.C. RATED



* Drywall contractor must install and finish fixture composite casting joint edges and drywall seam to blend the fixture with the ceiling.
 * Wiring must be done by the electrical contractor in accordance with NEC and applicable codes.
 You MUST coordinate the two trades for bidding and installation.

These are the types of components you have to build your continuous "Slot In The Ceiling":

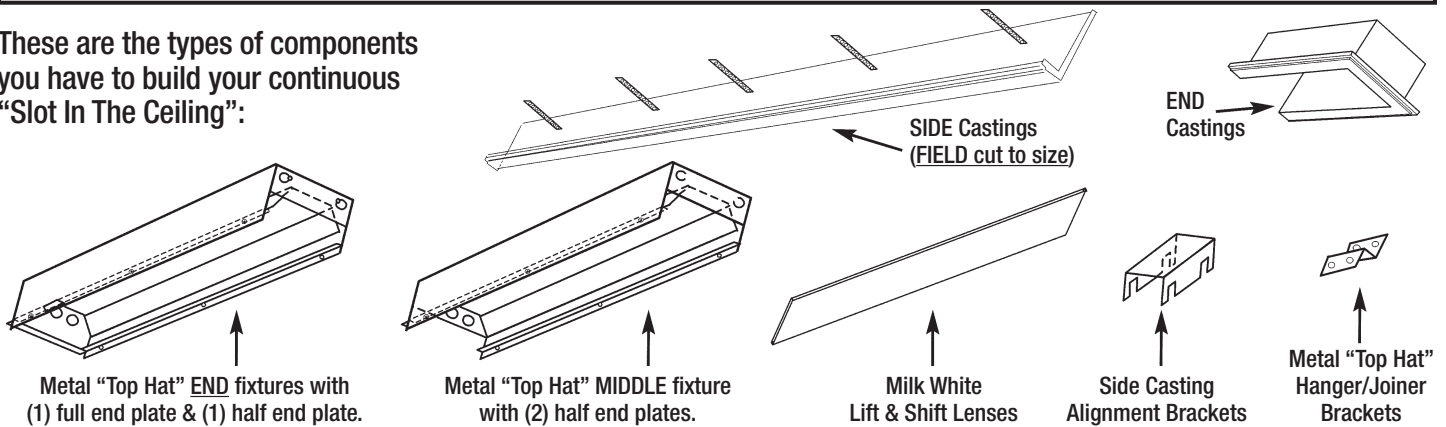

Additionally you will need to supply:

"Sikaflex 11-FC" Construction Adhesive (or equal), Course Thread 1-1/2' Drywall Screws, and Drill bits 5/32 & 7/64 sizes.

1. Frame opening with DOUBLE studs. Do NOT exceed 2" x 4" beams. Rough framed opening should be:

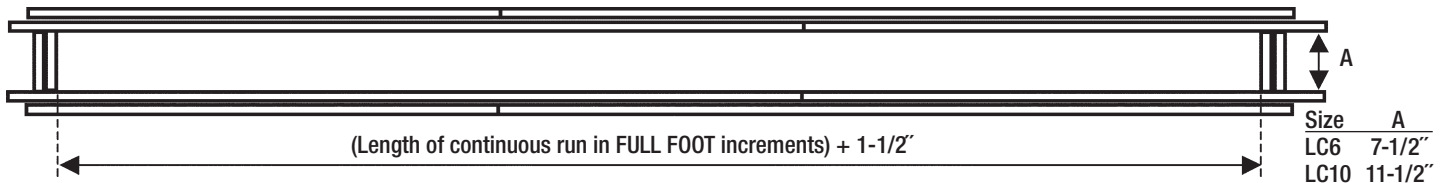

2. PRE-DRILL MOUNTING HOLES

where indicated in the bottom of the casting pieces with 5/32" Drill Bit. You will break the casting if you do not pre-drill holes.

3. Install each piece INDIVIDUALLY to properly align. When READY TO INSTALL:

A. Use "SIKAFLEX 11-FC"*** construction adhesive in a healthy, 1/4" bead where indicated.

B. Start with END piece. Place in position between beams and secure with Coarse Thread Drywall Screws, 1-1/2'.

DO NOT OVERTIGHTEN OR CASTING WILL BREAK!

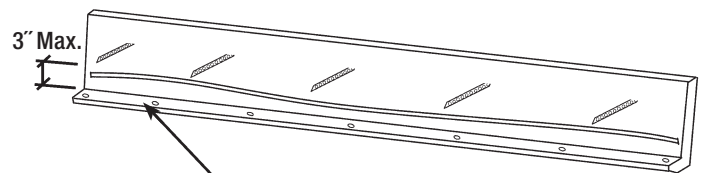
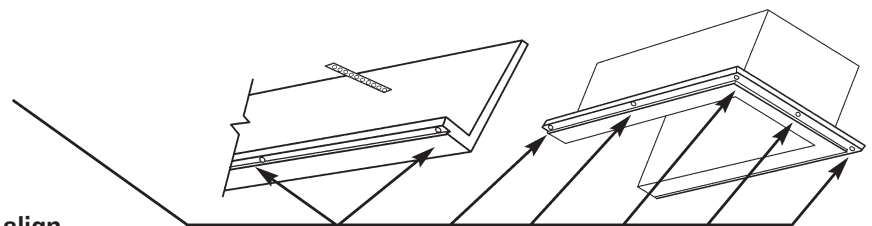

1/4" Bead of "SIKAFLEX 11-FC"* (or equal), by others.

Start building slot with END Casting.

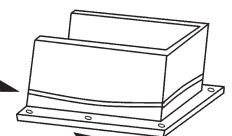

**ADHESIVE WILL NOT ALLOW ADJUSTMENT AFTER 30 min. IN 73° F. Permanent after 2 hrs. (can be sanded and painted).

INSTALLATION INSTRUCTIONS

Slot In The Ceiling Continuous Mounting (cont.)

- 4. Start with the END Casting and build along one side.** Bottom plane of casting should be even with the Finish of the Gypsum ceiling. Casting is made to butt 5/8" Gypsum.

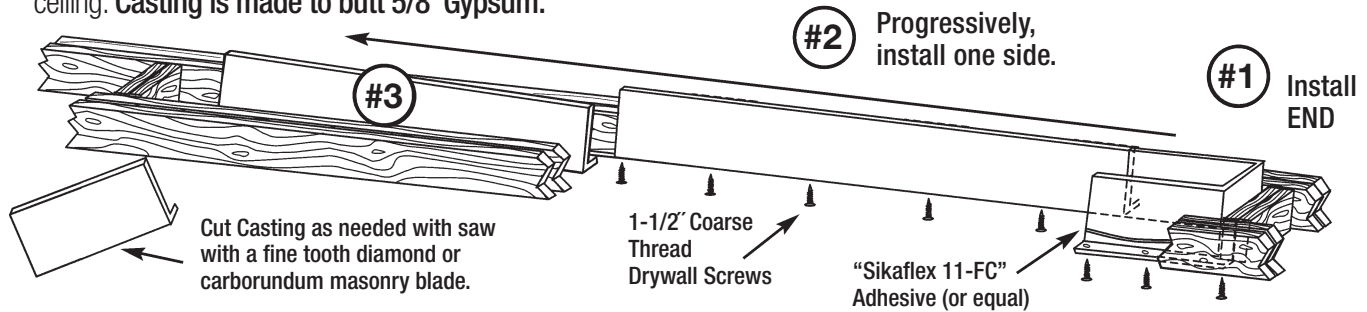

- 5. Put in place with "Sikaflex 11-FC" adhesive.** When in the correct position, **secure Strap to the structure** and use Coarse Thread 1-1/2" Drywall Screws through the casting at the ceiling. Align SIDE pieces with the slope of END casting as you build the row. **Cut 8' SIDE pieces as required with saw with a fine tooth diamond or carborundum masonry blade.**

DO NOT OVER TIGHTEN SCREWS – YOU WILL BREAK THE CASTING

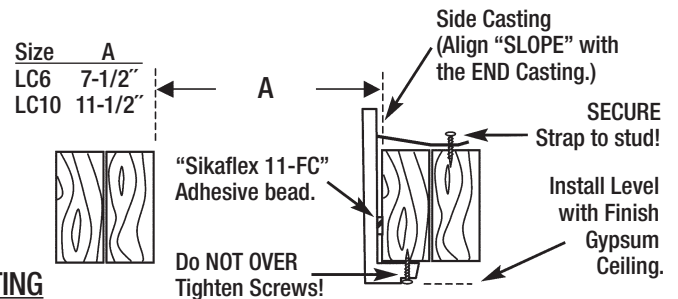

- 6. Place "Side Casting Alignment Brackets" in place to align castings along the second side.** You **MUST** use brackets to ensure the Electrical "Top Hat" fits.

Side Casting Alignment Brackets (will ensure metal housings fit above)

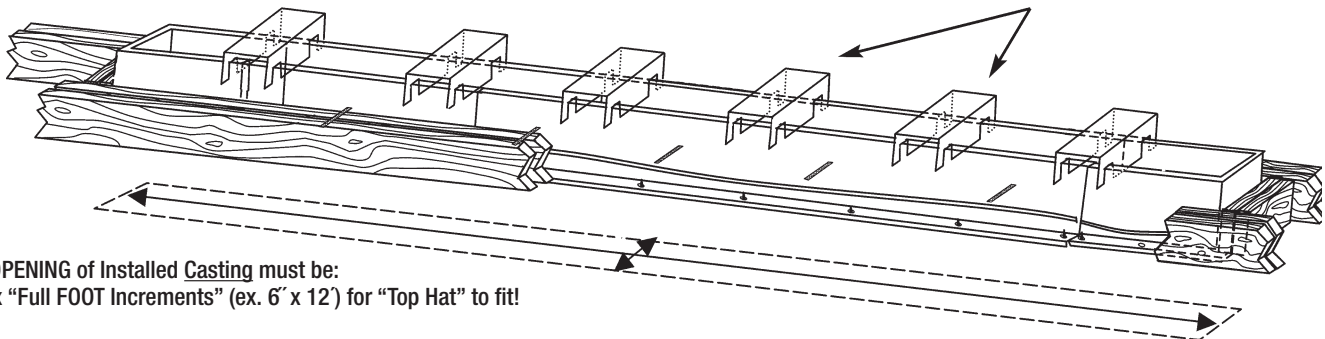

- 7. After Adhesive cures, use drywall tape & joint compound to finish inside casting joints (Top edge of casting MUST BE EVEN).** Then remove "Alignment Brackets."

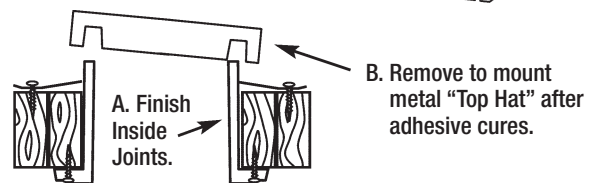

- 8. Electrical Contractor:** Put metal "Top Hat" fixture in place and align and secure housings together, then secure to structure with provided "Hanger/Joiner Brackets."

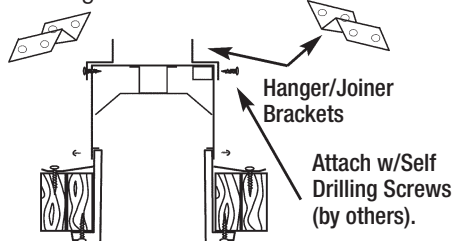

- 9. Drill holes (7/64 bit) to secure "Top Hat" to casting.**

DO NOT DRILL THRU 3/8" MAX!
Make power connections.

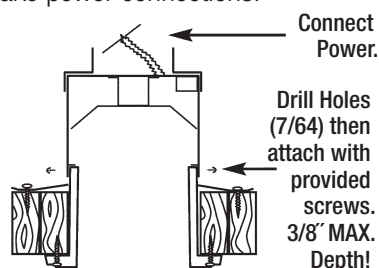

- 10. Drywall Contractor:**

Close up Ceiling and finish seams.

AFTER finish work Lamp & install Lift & Shift Lenses.

