

These instructions are to be used in addition to the standard "Series" drywall installation instructions, which detail reflector removal and other items not covered here.

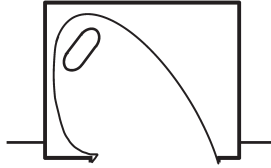

INSTALLATION INSTRUCTIONS

TRIMLESS OPTION DRYWALL / GYPSUM Mounting

FOR SUPPLY CONNECTIONS ENTERING THIS FIXTURE USE WIRE SUITABLE FOR AT LEAST 90° C

* INSTALLATION TO BE DONE IN ACCORDANCE WITH NEC AND APPLICABLE CODES *

ALUMINUM REFLECTOR CLEANING: Clean reflector with soap & water or alcohol, i.e. Isopropyl Alcohol or other neutral PH factor solvents. Cleaning material should be non-abrasive. **DO NOT** use Ammonia & alkali solutions.

1. Refer to chart for TRIMLESS housing dimensions:

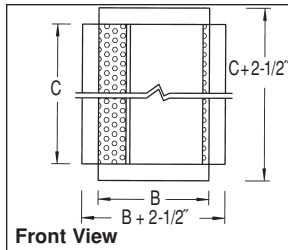
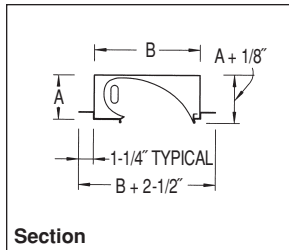

Rough-In Dimensions:

Individual Fixture = $(\text{"C"} + 1/2\text{'}) \times (\text{"B"} + 1/2\text{'})$
 Continuous Row = $(\text{Length of row, all "C" lengths} + 1/2\text{'}) \times (\text{"B"} + 1/2\text{'})$

A – Height of the recessed housing on the required Series catalog sheet.
B – Width of the recessed housing on the required Series catalog sheet.
C – Length of the recessed housing on the required Series catalog sheet (SEE CHART).
Sample: (HOUSING dimensions to assist with framing – does not include mounting flanges)
AK Series #140BXWW-AK 3-1/2"Ht. x 8-1/2"W x 22-15/16"L
AK Series TRIMLESS #140BXWW-AK-TLD 3-1/2"Ht. x 8-1/2"W x 24"L

CHART for "C" Dimension	Length of TRIMLESS Fixture Housing		
	2' nominal	3' nominal	4' nominal
AA, AAD, AK, DL, DW, ID, IW, MAXI & VT Series	C = 24"	C = 36"	C = 48"
MP & CW Series Fixtures:	C = 22-1/2"	C = 34-5/16"	C = 46-1/8"
All Series Fixtures less than 20" Length:	C = SAME length for Trimless		

2. Install framing for your specific type of installation per rough-in dimensions above. Fixtures for Individual installation have mounting flanges on all (4) sides to secure to framing. Continuous row installations are provided with flanges to allow end to end mounting as shown.

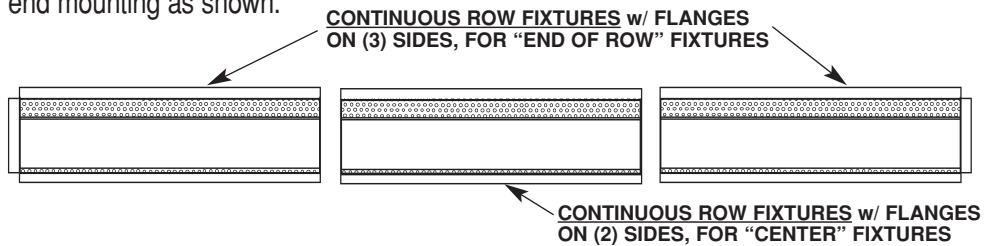
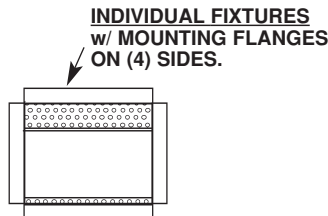

3. Secure the fixture to the structure per local codes. Housing should be mounted flush with the finish surface. Make wire connections through K.O.'s in the cover plate. Finish drywall surface to the fixture opening as shown.

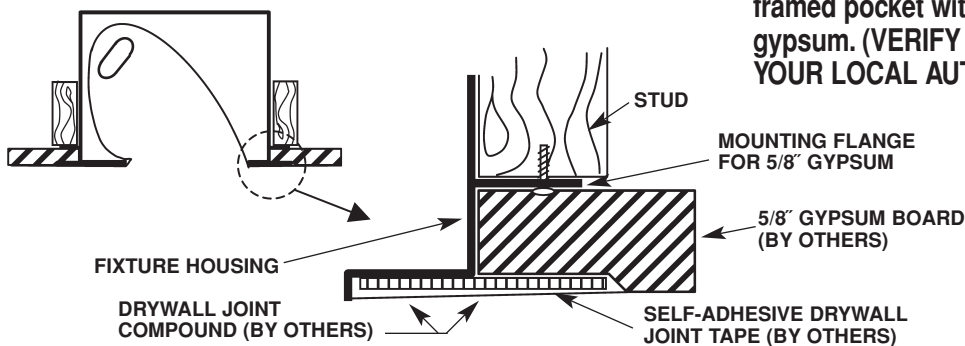

4. The AK and MP Series fixtures may be mounted in a standard stud wall. **NOTE: For one hour Fire rated wall – line the framed pocket with 5/8" gypsum. (VERIFY WITH YOUR LOCAL AUTHORITIES).**

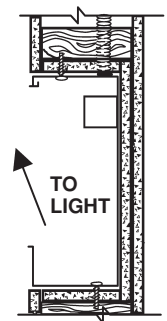

REPLACING THE REFLECTOR SHOULD BE THE LAST STEP – AFTER PAINTING AND FINISH WORK REMOVE THE PROTECTIVE PEEL AND REPLACE REFLECTOR.

These instructions are to be used in addition to the standard "Series" drywall installation instructions, which detail reflector removal and other items not covered here.

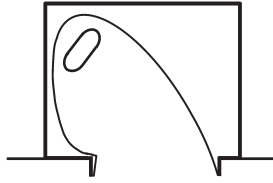

INSTALLATION INSTRUCTIONS

TRIMLESS OPTION PLASTER Mounting

FOR SUPPLY CONNECTIONS ENTERING THIS FIXTURE USE WIRE SUITABLE FOR AT LEAST 90° C

* INSTALLATION TO BE DONE IN ACCORDANCE WITH NEC AND APPLICABLE CODES *

ALUMINUM REFLECTOR CLEANING: Clean reflector with soap & water or alcohol, i.e. Isopropyl Alcohol or other neutral PH factor solvents. Cleaning material should be non-abrasive. **DO NOT** use Ammonia & alkali solutions.

1. Refer to chart for TRIMLESS housing dimensions:

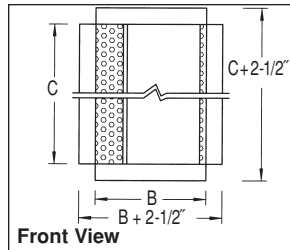
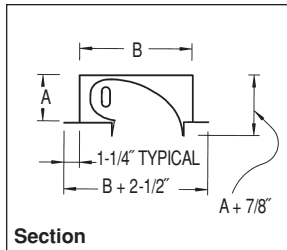

A – Height of the recessed housing on the required Series catalog sheet.
B – Width of the recessed housing on the required Series catalog sheet.
C – Length of the recessed housing on the required Series catalog sheet (SEE CHART).
Sample: (HOUSING dimensions to assist with framing – does not include mounting flanges)
AK Series #140BXWW-AK 3-1/2"Ht. x 8-1/2"W x 22-15/16"L
AK Series TRIMLESS #140BXWW-AK-TLP 3-1/2"Ht. x 8-1/2"W x 24"L

CHART for "C" Dimension	Length of TRIMLESS Fixture Housing		
	2' nominal	3' nominal	4' nominal
AA, AAD, AK, DL, DW, ID, IW, MAXI & VT Series	C = 24"	C = 36"	C = 48"
MP & CW Series Fixtures:	C = 22-1/2"	C = 34-5/16"	C = 46-1/8"
All Series Fixtures less than 20" Length:	C = SAME length for Trimless		

Rough-In Dimensions:

Individual Fixture = $(\text{"C"} + 1/2") \times (\text{"B"} + 1/2")$
 Continuous Row = $(\text{Length of row, all "C" lengths} + 1/2") \times (\text{"B"} + 1/2")$

2. Install framing for your specific type of installation per rough-in dimensions above. Fixtures for Individual installation have mounting flanges on all (4) sides to secure to framing. Continuous row installations are provided with flanges to allow end to end mounting as shown.

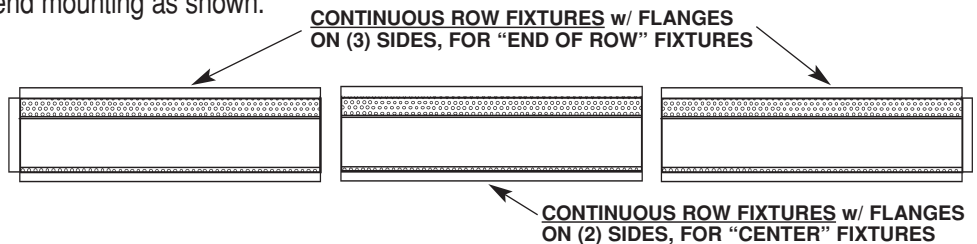
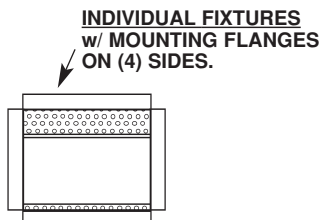

3. Secure the fixture to the structure per local codes. Housing should be mounted flush with the finish surface. Make wire connections through K.O.'s in the cover plate. Finish plaster surface to the fixture opening as shown.

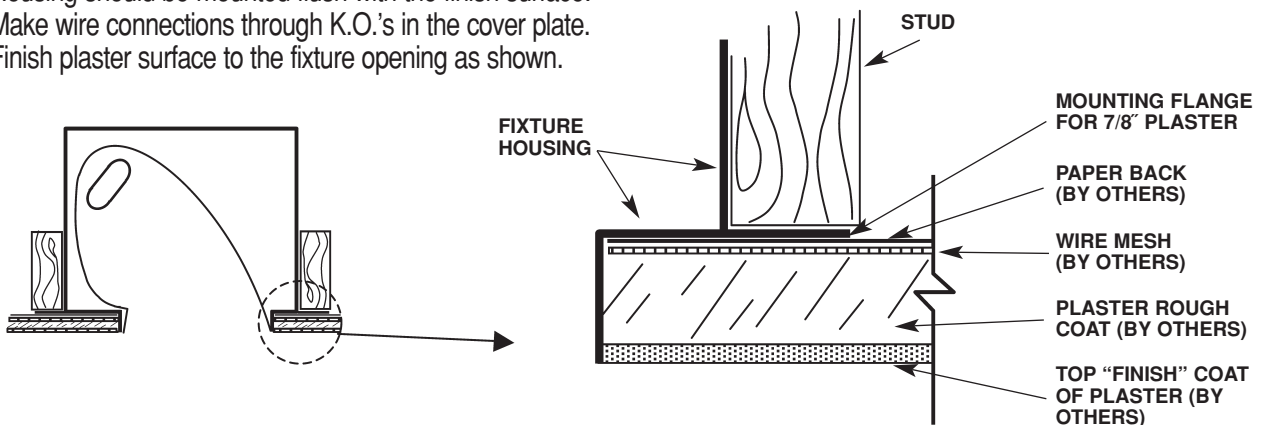

REPLACING THE REFLECTOR SHOULD BE THE LAST STEP – AFTER PAINTING AND FINISH WORK REMOVE THE PROTECTIVE PEEL AND REPLACE REFLECTOR.