

ENGINEERED
LIGHTING PRODUCTS



AILERON EXTRUSIONS

A6 SERIES

SURFACE/PENDENT Mount Wall Wash

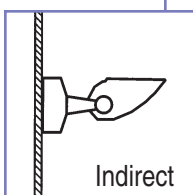

Indirect

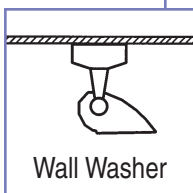

Wall Washer

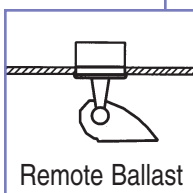

Remote Ballast

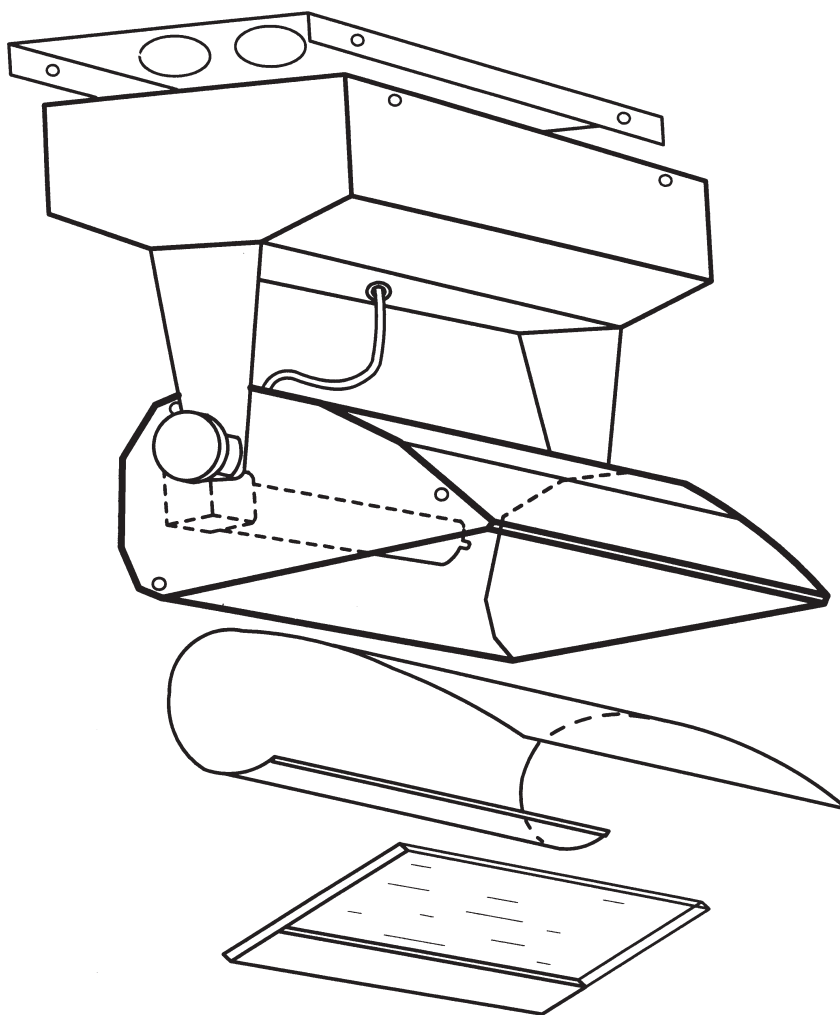

Metal Halide Fixture

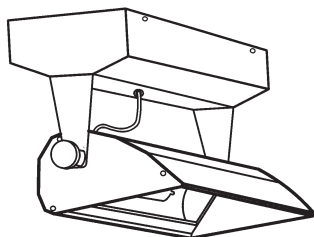

*Ideal placement is
24" to 36" from the
front edge of fixture
to the surface you
are lighting.*



TYPE:
CATALOG #:
JOB:

AILERON EXTRUSIONS

A6 SERIES

SURFACE/PENDENT Mount Wall Wash

SYSTEM

The "Aileron" A6 Series fixtures are surface/pendent mounted, extruded aluminum wall washers. Several mounting options offer complete adjustability. The formed aluminum reflector provides even unscalped illumination with no direct glare and offers exceptional lamp shielding. UL/CUL Damp Location listed.

U.S. Patent #5,142,459

SPECIFICATIONS

Surface mount extruded fixtures with an asymmetric wash of light for use with fluorescent, metal halide and tungsten halogen quartz lamps. The fixture is extruded aluminum that is TGIC polyester powder coated. The one-piece, formed reflector is high-purity aluminum (99.9%) with 95% reflectance. It is easily removable without tools.

OPTIONS

| | |
|-----------|--|
| Ballast | 120 HPF Electronic (Standard) 277 HPF Electronic Dimming (Some models) -DM Emergency (Some models) -EPP |
| Finish | White (Standard) Custom -Custom |
| Reflector | Diffuse Silver (Standard) White -W |
| Lens | Mini Lens -ML Full Lens -FL |
| Louver | Parallel Blade Louver -LV |
| Mounting | Must be Specified (except Metal Halide) |

Note: Standard T-5 lamps are available:
2' fixtures, replace the "24" with "14"
3' fixtures, replace the "39" with "21"
4' & 8' fixtures, replace the "54" with "28"

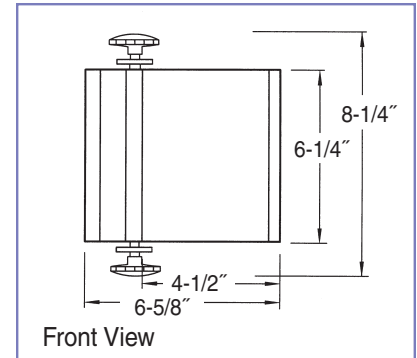
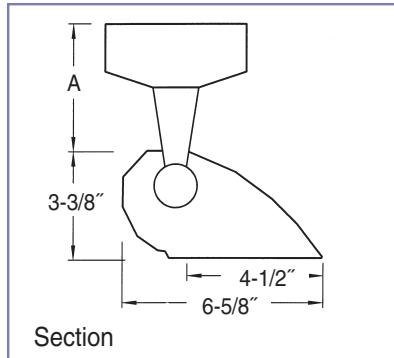

Metal Halide Lamps (*not for use in dwellings*)

| Model No. | A | Lamp |
|-------------|--------|---------------------------|
| 139MHWW-A6 | 5-1/4" | 39 watt T-6 Metal Halide |
| 170MHWW-A6 | 5-1/4" | 70 watt T-6 Metal Halide |
| 1150MHWW-A6 | 6" | 150 watt T-6 Metal Halide |

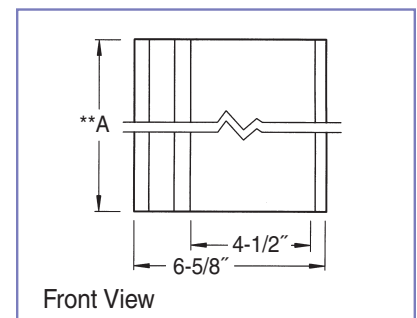
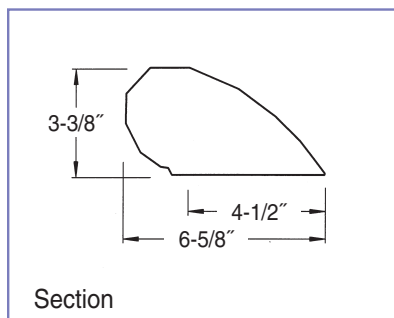

Quartz Halogen and Fluorescent Lamps (*remote ballast only*)

| Model No. | **A | Lamp |
|---------------|---------|--|
| 1250QHWW-A6* | 8 | 75 to 250 watt Quartz Halogen Mini-can |
| 140BXWW-A6* | 24-1/4" | 40 watt Biax |
| 150BXWW-A6* | 24-1/4" | 50 watt Biax |
| 155BXWW-A6* | 24-1/4" | 55 watt Biax |
| 240BXWW-A6* | 48-1/4" | (2) 40 watt Biax |
| 250BXWW-A6* | 48-1/4" | (2) 50 watt Biax |
| 255BXWW-A6* | 48-1/4" | (2) 55 watt Biax |
| 440BXWW-A6* | 96-1/2" | (4) 40 watt Biax |
| 450BXWW-A6* | 96-1/2" | (4) 50 watt Biax |
| 455BXWW-A6* | 96-1/2" | (4) 55 watt Biax |
| 124 T-5WW-A6* | 24-1/4" | 24 watt T-5 HO |
| 139 T-5WW-A6* | 36-1/4" | 39 watt T-5 HO |
| 154 T-5WW-A6* | 48-1/4" | 54 watt T-5 HO |
| 254 T-5WW-A6* | 96-1/2" | (2) 54 watt T-5 HO |
| 117 T-8WW-A6* | 24-1/4" | 17 watt T-8 |
| 125 T-8WW-A6* | 36-1/4" | 25 watt T-8 |
| 132 T-8WW-A6* | 48-1/4" | 32 watt T-8 |
| 232 T-8WW-A6* | 96-1/2" | (2) 32 watt T-8 |



AILERON MOUNTING

HALOGEN & FLUORESCENT A6 SERIES
A9 SERIES

Mounting must be specified.

WALL MOUNT

Direct & Indirect fixtures mount directly to a horizontal single gang switchbox. Square canopy adapter is available for mounting to a 4" x 4" junction box (add **-C4**).



Direct (A9 Only)

Ordering: Add **-WD** to catalog number
Add **-WD-W** (White reflector if you want
light splash on wall)

Sample: **240BXWW-A9-WD**



Indirect (A9 Only)

Ordering: Add **-WI** to catalog number
Add **-WI-W** (White reflector if you want
light splash on wall)

Sample: **440BXWW-A9-WI-W**

YOKE MOUNT

The yoke mounts directly to the ceiling or structure using drywall bolts or screws (by others). Adjustable knobs allow versatile aiming.

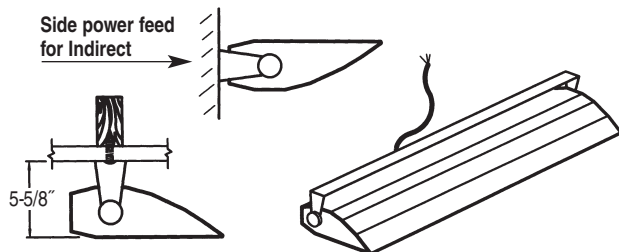

Yoke (Up to 4' Length Fixture)

Ordering: Add **-Y** to catalog number (**-YI** for Indirect)
Add **-Y-W** (White reflector if you want light
splash on wall) (**-YI-W** for Indirect)

Sample: **240BXWW-A9-Y**

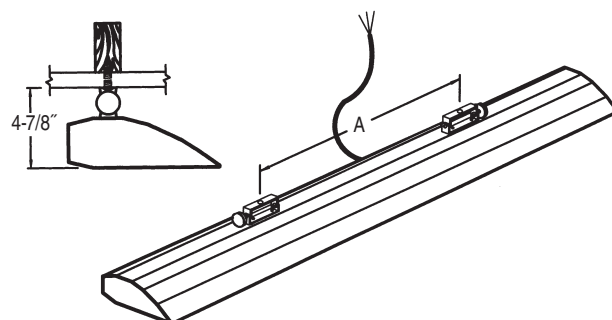

Yoke (8' Length Fixture)

Ordering: Add **-MY** to catalog number

Sample: **440BXWW-A9-MY**

CANOPY MOUNT

Supplied with hardware to mount directly to a J-Box. The 2', 3', 4' and 8' fixtures are supplied with two canopies.

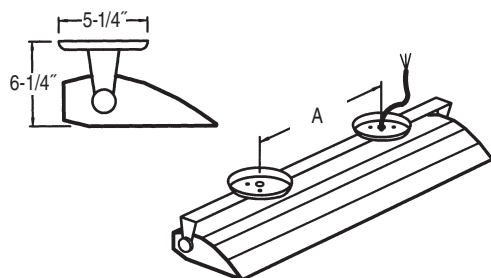

Canopy (Up to 4' Length Fixture)

Ordering: Add **-CY** to catalog number

Sample: **240BXWW-A9-CY**

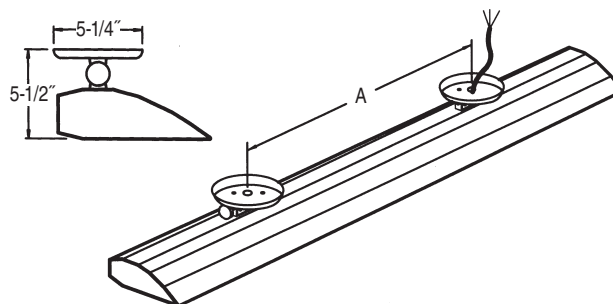

Canopy (8' Length Fixture)

Ordering: Add **-CMY** to catalog number

Sample: **440BXWW-A9-CMY**

| Fixture Length | A |
|----------------|-----|
| 2' Fixture | 18" |
| 3' Fixture | 24" |
| 4' Fixture | 24" |
| 8' Fixture | 48" |



AILERON MOUNTING

**HALOGEN & FLUORESCENT A6 SERIES
A9 SERIES**

Mounting must be specified.

CANOPY & STEM

Supplied with hardware to mount directly to a J-Box. Stems provided from 1' to 10' as required. The 2', 3', 4' & 8' fixtures are provided with two.

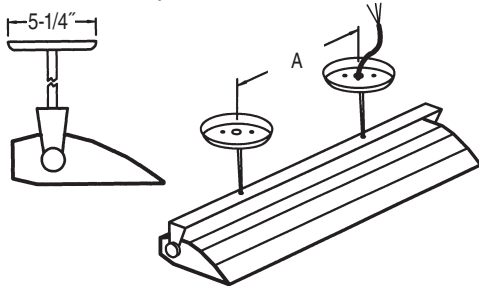

| Fixture Length | A |
|----------------|-----|
| 2' Fixture | 18" |
| 3' Fixture | 24" |
| 4' Fixture | 24" |
| 8' Fixture | 48" |

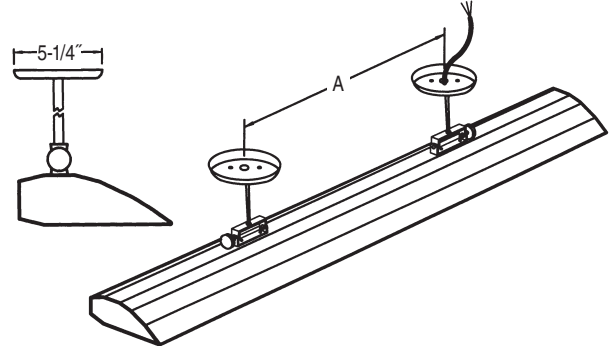

Adjustable (Up to 4' Length Fixture)

Ordering: Add **-CSY** (stem length required)

Sample: **240BXWW-A9-CSY2**

Adjustable (8' Length Fixture)

Ordering: Add **-CSMY** (stem length required)

Sample: **440BXWW-A9-CSMY2**

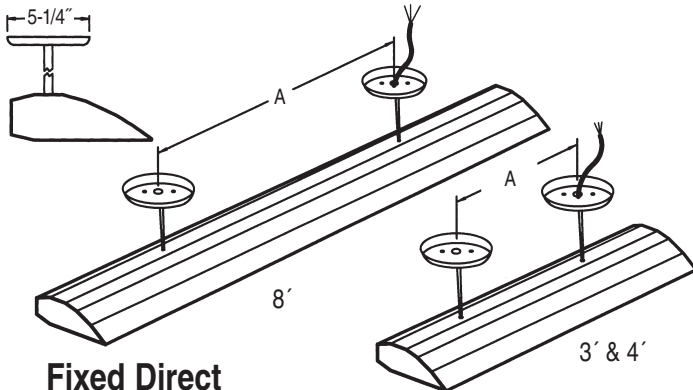

Fixed Direct

Ordering: Add **-CS** (stem length required)

Sample: **240BXWW-A9-CS2**

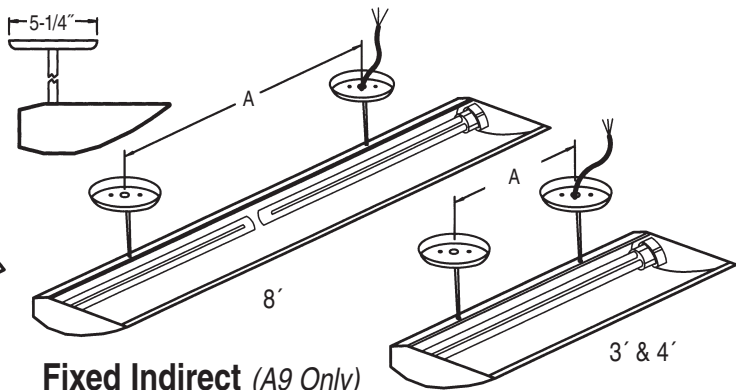

Fixed Indirect (A9 Only)

Ordering: Add **-CSI** (stem length required)

Sample: **440BXWW-A9-CSI2**

CABLE MOUNT

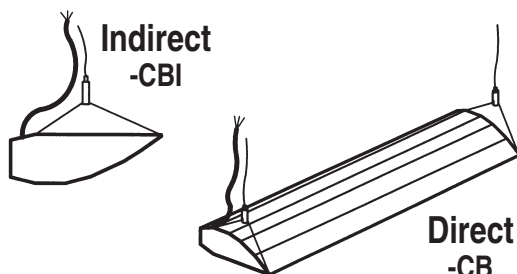

**Indirect
-CBI**

**Direct
-CB**

Ordering: Add **-CB** (cable length required)
Add **-CBI** (cable length required)

Sample: **240BXWW-A9-CB8**

TRACK MOUNT

Adapters can be supplied for Con-Tech track, which is U.L. compatible with Juno. For all other track, adapters must be supplied by others. All 2', 3' & 4' fixtures provided with two.

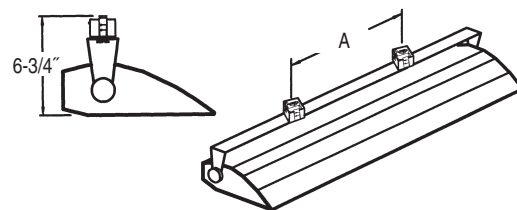

Track (Up to 4' Only)

Ordering: Add **-TK** to catalog number

Sample: **240BXWW-A9-TK**