

ENGINEERED
LIGHTING PRODUCTS

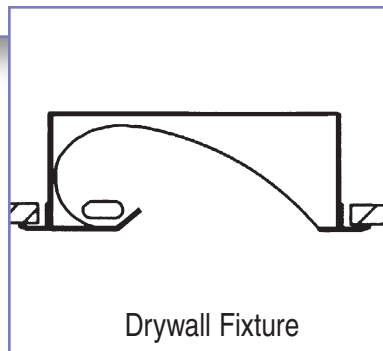

IW & IWTB SERIES

*RECESSED Indirect for Vertical Illumination
For Drywall and T-Bar*

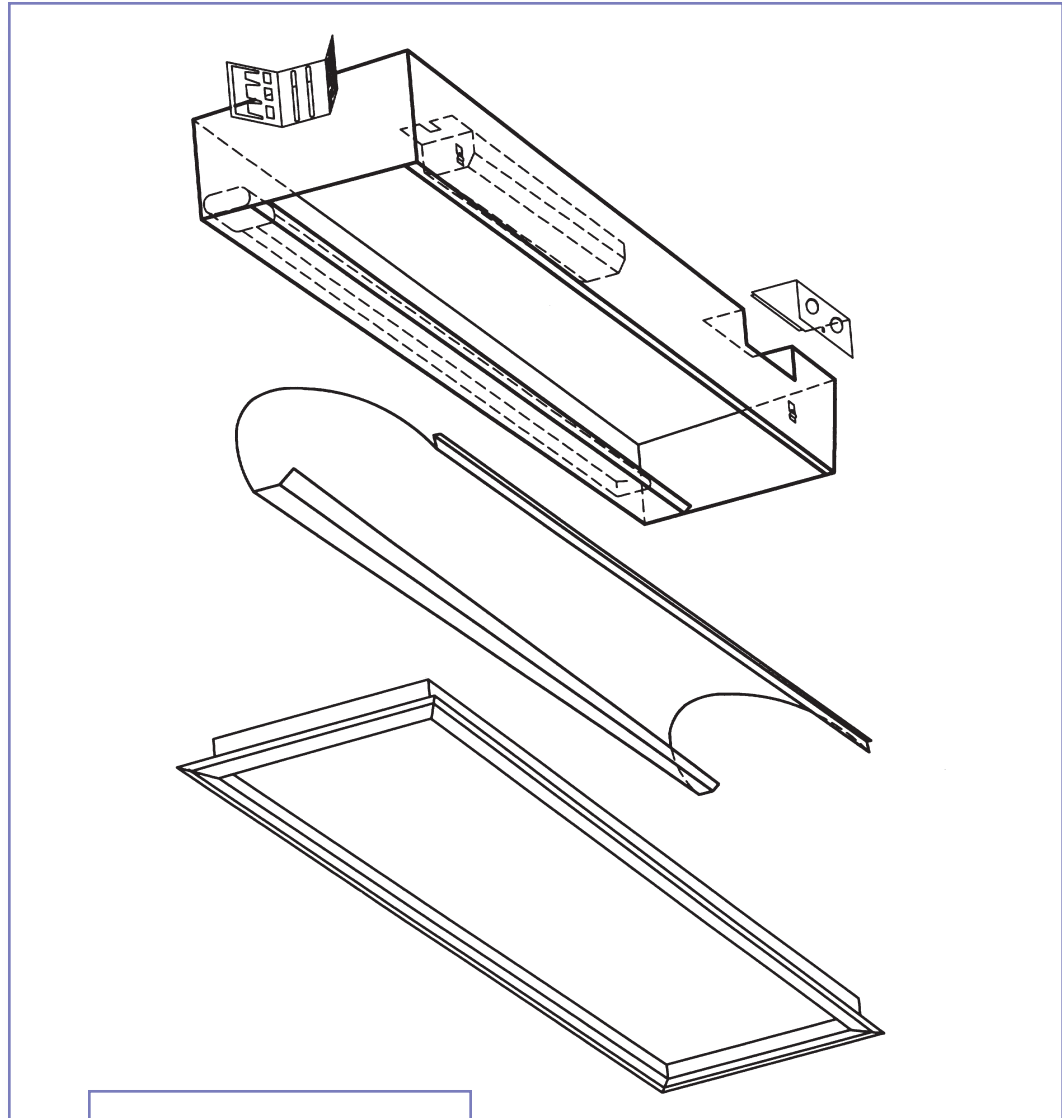

Drywall Fixture

*Ideal placement is
24" to 36" from the
front edge of fixture
to the surface you
are lighting.*



TYPE:
CATALOG #:
JOB:

IW & IWTB SERIES

*RECESSED Indirect for Vertical Illumination
For Drywall and T-Bar*

SYSTEM

Recessed indirect fixture with asymmetric wash of light to provide vertical illumination in difficult applications such as mirrors and video conference key speakers where a shielded lamp is critical. The formed reflector provides even, unscalped illumination with no direct glare. UL/CUL Damp Location listed.

U.S. Patent #5,142,459

SPECIFICATIONS

Recessed indirect fixture with asymmetric wash of light to provide vertical illumination. Available in 2' and 4' lengths for use with Biax and T-5 lamps. The formed reflector combines white diffuse with high-purity aluminum (99.9%) reflector material with 95% reflectance. It is easily removable without tools for access to the ballast and wiring. Fixture design provides complete lamp shielding from all angles.

The 5" deep, TGIC polyester powder-coated housing is made of 22 gauge CRS with cover and knock-outs that provide quick wire access to the side or back of the fixture for through wiring.

OPTIONS

Ballast	120 HPF Electronic (Standard) 277 HPF Electronic Dimming (Some Models) -DM Emergency (Some Models) -EPP
Finish	White (Standard) Custom -Custom
Reflector	Combo White/Diffuse (Standard) White -W
Louver	Parallel Blade Louver -LV

Note: T-8 Lamp fixtures are available for Plaster or Drywall applications. Call factory for information.

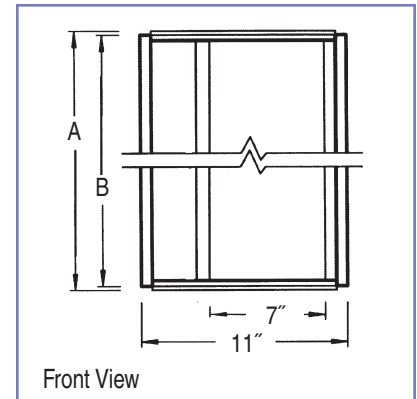
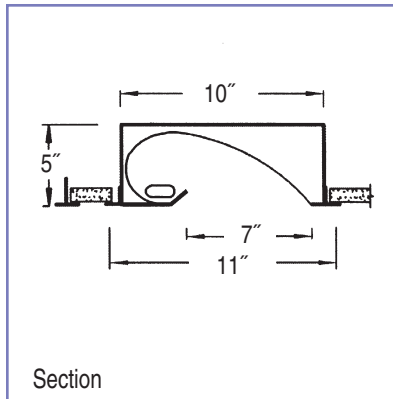

IW-TB SERIES for T-Bar Installations

Model No.	A	B	Lamp
140 BXIW-TB	23-7/8"	23-7/16"	40 watt Biax
150 BXIW-TB	23-7/8"	23-7/16"	50 watt Biax
155 BXIW-TB	23-7/8"	23-7/16"	55 watt Biax
240 BXIW-TB	47-7/8"	47-7/16"	(2) 40 watt Biax
250 BXIW-TB	47-7/8"	47-7/16"	(2) 50 watt Biax
255 BXIW-TB	47-7/8"	47-7/16"	(2) 55 watt Biax
114 T-5IW-TB	23-7/8"	23-7/16"	14 watt T-5
124 T-5IW-TB	23-7/8"	23-7/16"	24 watt T-5 HO
128 T-5IW-TB	47-7/8"	47-7/16"	28 watt T-5
154 T-5IW-TB	47-7/8"	47-7/16"	54 watt T-5 HO

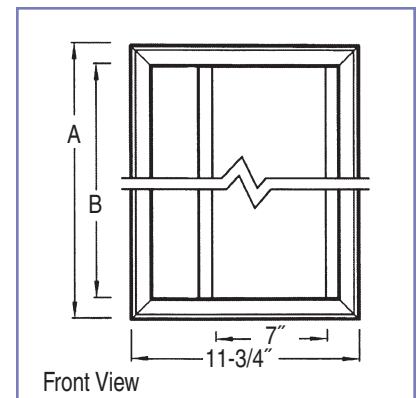
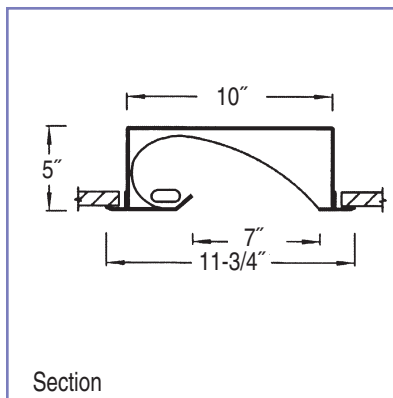

IW SERIES for Plaster or Drywall

Model No.	A	B	Rough-In Dimensions	Lamp
140 BXIW	24-11/16"	22-15/16"	10-5/8" x 23-1/2"	40 watt Biax
150 BXIW	24-11/16"	22-15/16"	10-5/8" x 23-1/2"	50 watt Biax
155 BXIW	24-11/16"	22-15/16"	10-5/8" x 23-1/2"	55 watt Biax
240 BXIW	48-11/16"	46-15/16"	10-5/8" x 47-1/2"	(2) 40 watt Biax
250 BXIW	48-11/16"	46-15/16"	10-5/8" x 47-1/2"	(2) 50 watt Biax
255 BXIW	48-11/16"	46-15/16"	10-5/8" x 47-1/2"	(2) 55 watt Biax
114 T-5IW	24-11/16"	22-15/16"	10-5/8" x 23-1/2"	14 watt T-5
124 T-5IW	24-11/16"	22-15/16"	10-5/8" x 23-1/2"	24 watt T-5 HO
128 T-5IW	48-11/16"	46-15/16"	10-5/8" x 47-1/2"	28 watt T-5
154 T-5IW	48-11/16"	46-15/16"	10-5/8" x 47-1/2"	54 watt T-5 HO