

ENGINEERED  
LIGHTING PRODUCTS

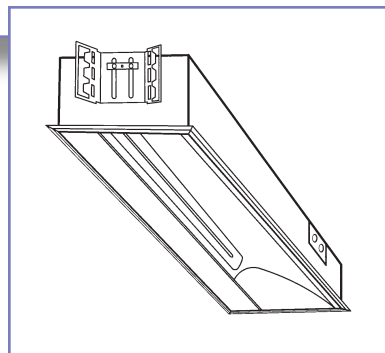

# MAXI SERIES

*RECESSED Wall Washer  
For High Plaster or Drywall Ceilings*

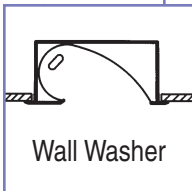
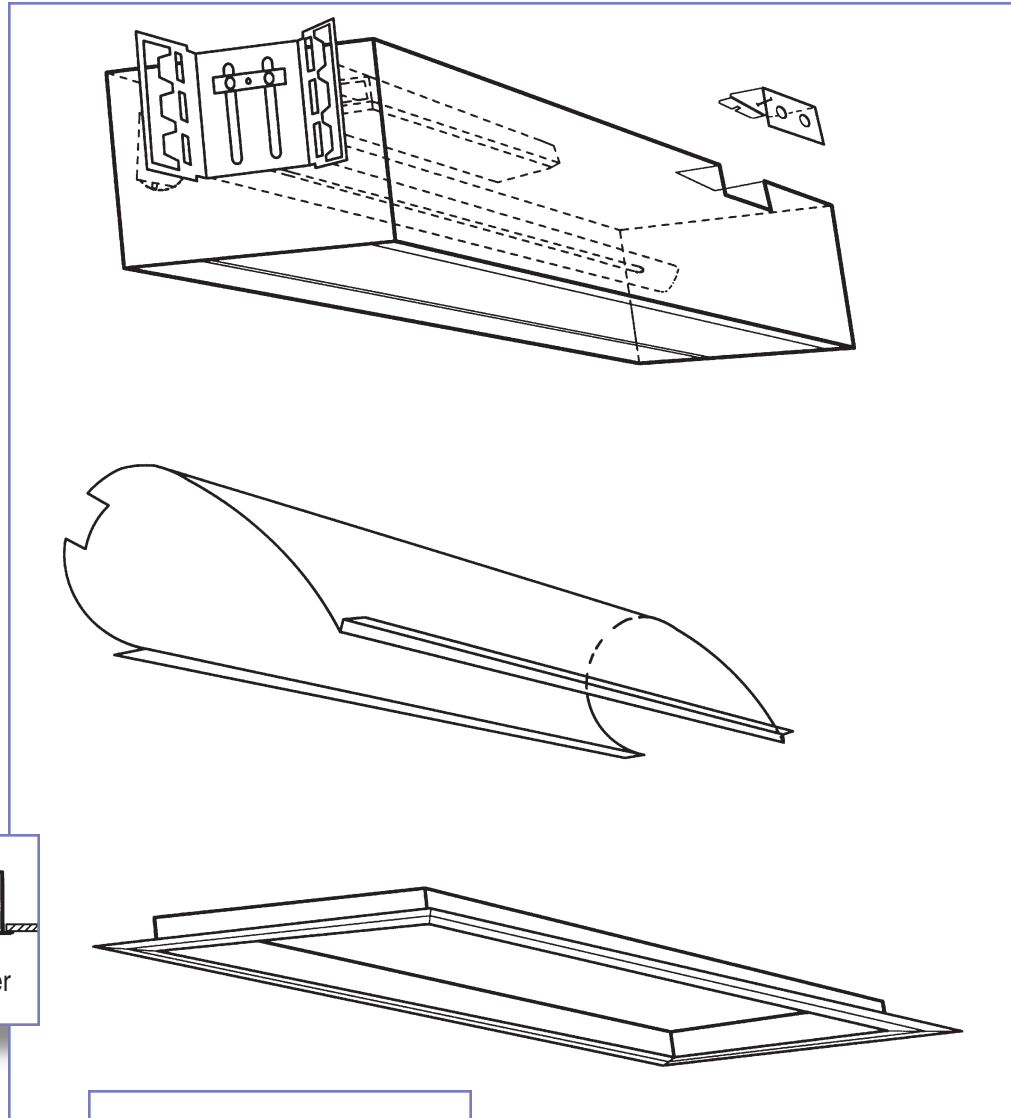

*Ideal placement  
(depending on wall height)  
is 48" to 66" from the front  
edge of fixture to the  
surface you are lighting.*



TYPE:  
CATALOG #:  
JOB:

# MAXI SERIES

*RECESSED Wall Washer  
For High Plaster or Drywall Ceilings*

## SYSTEM

The optical performance of the Maxi wall wash fixture was designed specifically for retail spaces with 12' to 14' ceilings. They provide 40% more light than typical wall wash fixtures in the critical merchandise area from 4' to 7' height while maintaining even illumination on the wall (within a 4:1 ratio). Utilizes Biax, T-5 or T-8 lamps. The formed aluminum reflector provides even unscalped illumination with no glare and offers exceptional lamp shielding. UL/CUL Damp Location listed.

U.S. Patent #5,142,459

## SPECIFICATIONS

Recessed fluorescent washer for use with Biax, T-5 and T-8 lamps for drywall installations. The fixture is 5" deep with ballast(s) mounted in the housing. The one-piece formed reflector is high-purity aluminum (99.9%) with 95% reflectance. It is easily removable without tools for access to the ballast and wiring. Reflector design provides complete lamp shielding even when viewed directly beneath the fixture.

TGIC polyester powder-coated housing is made of 22 gauge CRS with cover and knock-outs that provide quick wire access to side or back of fixture for through wiring. Trim is extruded aluminum.

**Continuous Mount** – If the fixtures are being mounted in a continuous row in the ceiling, add "CC" to the catalog number and provide the row configuration (i.e. (6) 12' rows).

Rough-in Dimension = (Entire length of row, add all "B" lengths + 1/2") x 10-5/8".

## OPTIONS

Ballast	120 HPF Electronic (Standard) 277 HPF Electronic Dimming (Some models) -DM Emergency (Some models) -EPP Magnetic -MG
Finish	White (Standard) Custom -Custom
Reflectors	Diffuse Silver (Standard) Specular Silver -SP Painted White -W
Lens	Full Lens -FL **
Louver	Parallel Blade Louver -LV
Trimless	Plaster to Fixture Opening - TL (Openings is 7-1/2" x B" dim.)

\*\* Full Lens attaches in the trim frame for single units, however it must attach with screws for all "CC" (Continuous) units, mounted end to end.

© 2003 Engineered Lighting Products 1998/Rev. 2003

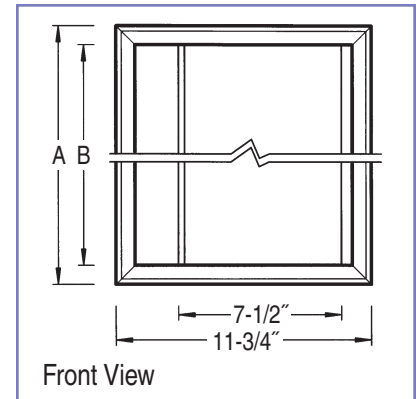
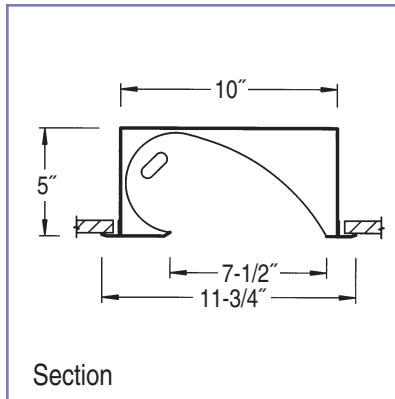

Model No.	A	B	Rough-in Dimensions	Lamp
140 BXWW-M	24-11/16"	22-15/16"	10-5/8" x 23-1/2"	40 watt Biax
150 BXWW-M*	24-11/16"	22-15/16"	10-5/8" x 23-1/2"	50 watt Biax
155 BXWW-M*	24-11/16"	22-15/16"	10-5/8" x 23-1/2"	55 watt Biax
240 BXWW-M2†	24-11/16"	22-15/16"	10-5/8" x 23-1/2"	(2) 40 watt Biax
250 BXWW-M2*†	24-11/16"	22-15/16"	10-5/8" x 23-1/2"	(2) 50 watt Biax
255 BXWW-M2*†	24-11/16"	22-15/16"	10-5/8" x 23-1/2"	(2) 55 watt Biax
240 BXWW-M	48-11/16"	46-15/16"	10-5/8" x 47-1/2"	(2) 40 watt Biax
250 BXWW-M*	48-11/16"	46-15/16"	10-5/8" x 47-1/2"	(2) 50 watt Biax
255 BXWW-M*	48-11/16"	46-15/16"	10-5/8" x 47-1/2"	(2) 55 watt Biax
440 BXWW-M†	48-11/16"	46-15/16"	10-5/8" x 47-1/2"	(4) 40 watt Biax
450 BXWW-M†	48-11/16"	46-15/16"	10-5/8" x 47-1/2"	(4) 50 watt Biax
455 BXWW-M†	48-11/16"	46-15/16"	10-5/8" x 47-1/2"	(4) 55 watt Biax
214 T-5WW-M*	24-11/16"	22-15/16"	10-5/8" x 23-1/2"	(2) 14 watt T-5
224 T-5WW-M*	24-11/16"	22-15/16"	10-5/8" x 23-1/2"	(2) 24 watt T-5 HO
221 T-5WW-M*	37-3/4"	36"	10-5/8" x 36-1/2"	(2) 21 watt T-5
239 T-5WW-M*	37-3/4"	36"	10-5/8" x 36-1/2"	(2) 39 watt T-5 HO
228 T-5WW-M*	48-11/16"	46-15/16"	10-5/8" x 47-1/2"	(2) 28 watt T-5
254 T-5WW-M*	48-11/16"	46-15/16"	10-5/8" x 47-1/2"	(2) 54 watt T-5 HO
217 T-8WW-M†	25-3/4"	24"	10-5/8" x 24-1/2"	(2) 17 watt T-8
225 T-8WW-M*	37-3/4"	36"	10-5/8" x 36-1/2"	(2) 25 watt T-8
232 T-8WW-M†	49-3/4"	48"	10-5/8" x 48-1/2"	(2) 32 watt T-8

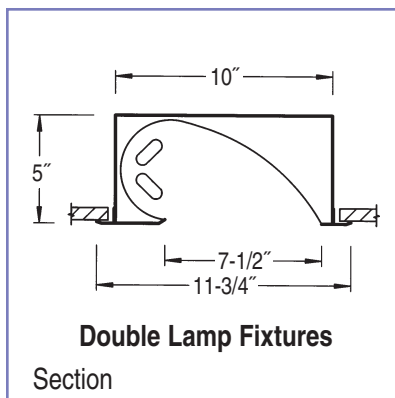

\* Magnetic ballast not available.  
† Double lamp fixtures.