

ENGINEERED
LIGHTING PRODUCTS

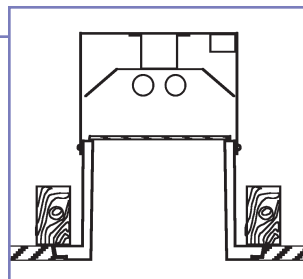

SITC SERIES

RECESSED Slot In The Ceiling Light Niche
For Plaster or Drywall

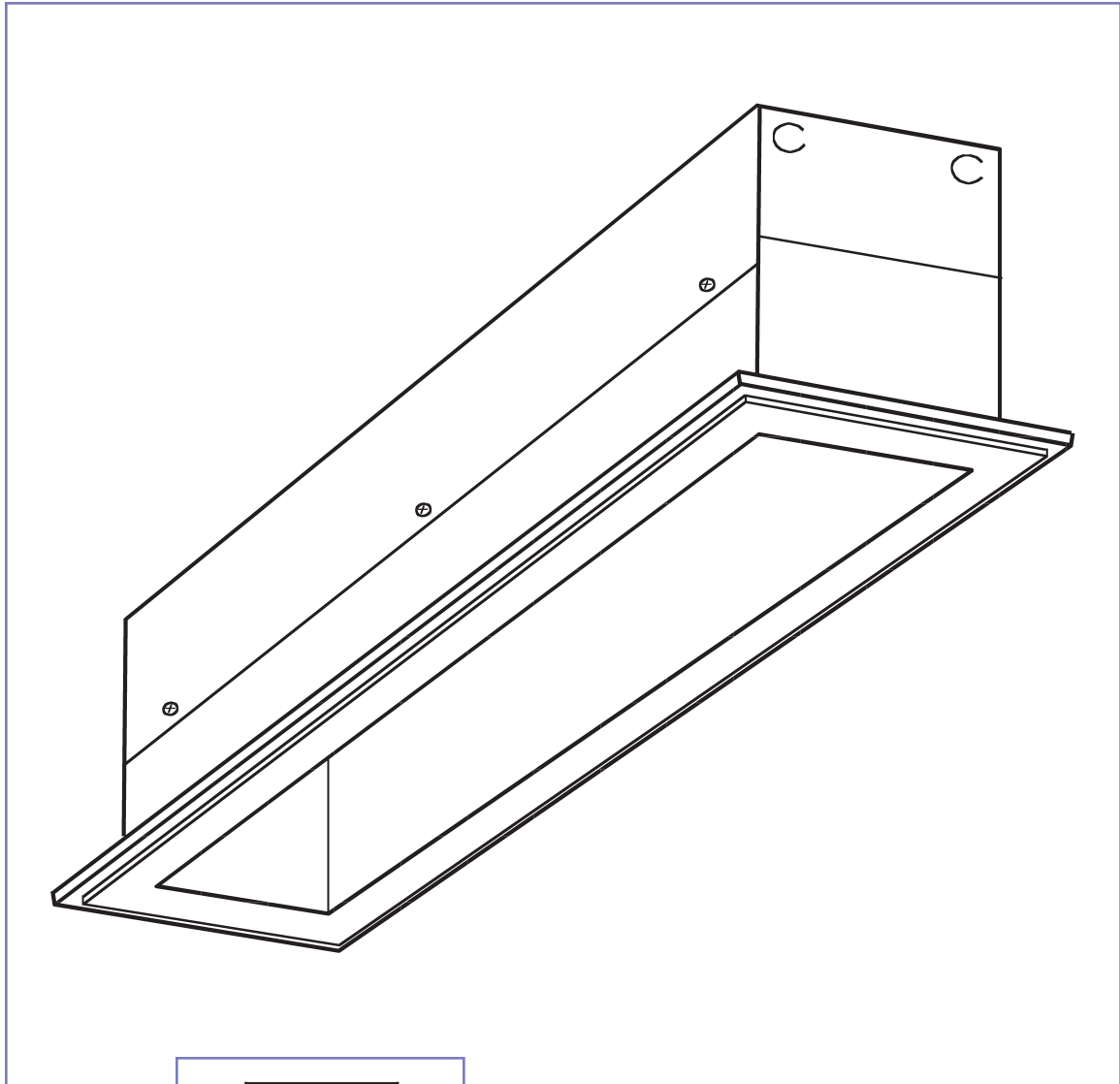

*Individual or Continuous,
Cast rectangular downlights
that integrate into your ceiling
to create a "slot" of light
for a custom built look of
a drywall light niche.*

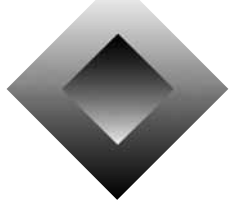

TYPE:
CATALOG #:
JOB:

SYSTEM

Recessed, GRG (Glass-fiber Reinforced Gypsum) rectangular downlight fixture. The cast plaster fixture actually appears to be part of your ceiling. It looks like a custom formed drywall "light niche" that blends with any interior motif. Frosted lens standard. Non I.C. rated.

UL/CUL Damp Location Listed.

Patent Pending.

SPECIFICATIONS

Recessed fixture for use with 40, 50 and 55 watt Biax, T-5 or T-8 fluorescent lamps. The cast, GRG fixture is glass-fiber reinforced gypsum with integral electrical components. All electrical components are accessible through the fixture opening. Individual 2' and 4' units or continuous installations are available. For continuous "slots" of light, 8' sections are provided that may be field cut. Two, 1' end-caps are supplied for each continuous "slot." The lighting components that mount above the cast GRG "slot" are provided in 2', 3' and 4' sections. These weld construction components are TGIC polyester powder coated and come complete with formed, matte white reflector, ballast and sockets. The integration of lighting component and casting is designed for easy installation. Casting mounts directly to stud construction. Allowance is made for 5/8" gypsum board construction butting the casting.

OPTIONS

Ballast	120 Electronic (Standard) 277 Electronic Dimming -DM
Lens	Frosted Lens (Standard) Milk White Acrylic -ML-MW
Louver	Parallel Blade Louver -LV Louder & Frosted Lens - ML-F-LV

NOTE: The fixture castings should be installed by the drywall contractor and the lighting components installed and wired by the electrical contractor.

CONTINUOUS ROW INSTALLATIONS

Continuous row installations must be coordinated with the factory. Lighting components that mount above the castings are available in 2', 3' and 4' units.

SITC SERIES

RECESSED Slot In The Ceiling Light Niche
For Plaster or Drywall

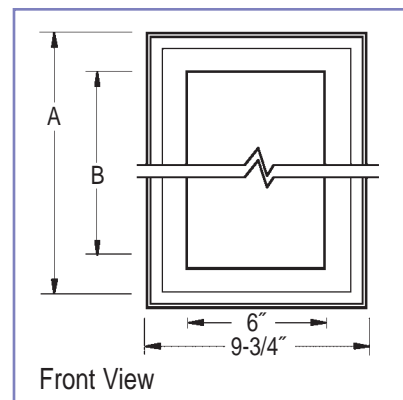
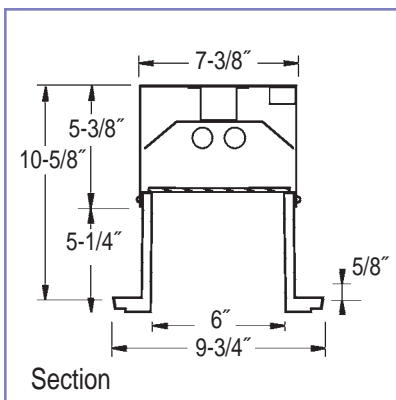

Individual Units

Model No.	A	B	Lamp
140 BX-SITC	27-3/4"	24"	40 watt Biax
150 BX-SITC	27-3/4"	24"	50 watt Biax
155 BX-SITC	27-3/4"	24"	55 watt Biax
240 BX-SITC-2	27-3/4"	24"	(2) 40 watt Biax
250 BX-SITC-2	27-3/4"	24"	(2) 50 watt Biax
255 BX-SITC-2	27-3/4"	24"	(2) 55 watt Biax
240 BX-SITC	49-3/4"	48"	(2) 40 watt Biax
250 BX-SITC	49-3/4"	48"	(2) 50 watt Biax
255 BX-SITC	49-3/4"	48"	(2) 55 watt Biax
440 BX-SITC	49-3/4"	48"	(4) 40 watt Biax
450 BX-SITC	49-3/4"	48"	(4) 50 watt Biax
455 BX-SITC	49-3/4"	48"	(4) 55 watt Biax
224 T-5-SITC*†	27-3/4"	24"	(2) 24 watt T-5 HO
254 T-5-SITC*†	49-3/4"	48"	(2) 54 watt T-5 HO
217 T-8-SITC*	27-3/4"	24"	(2) 17 watt T-8
232 T-8-SITC*	49-3/4"	48"	(2) 32 watt T-8

* Single lamp units are also available.

†Standard T-5 lamps are also available.

Typical 10' CONTINUOUS ROW

